

1.5mm Cable Display Systems - INSTALLATION GUIDELINES

Panel Fixing - CG14 & CG08 Support Installation

1) Attach a clamp support to each corner of vertical panel at min. 1" distance from edge (fig 1).

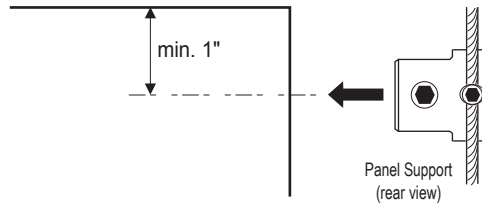

fig 1

2) Use additional clamp supports for panels taller than 60 inches to avoid bowing.

3) **Mark cable positions on floor area** - measure the distance between cable centers and mark cable positions on floor. With the use of a plumb line mark and fix cables to ceiling (ensuring that fixings are secure).

5) Install cables as per "**Cable Fixing Instructions**" for CA4 supplied.

6) Fix panels onto cables. Adjust panels vertically and horizontally, preferably with a spirit level. Repeat procedure for other panels.

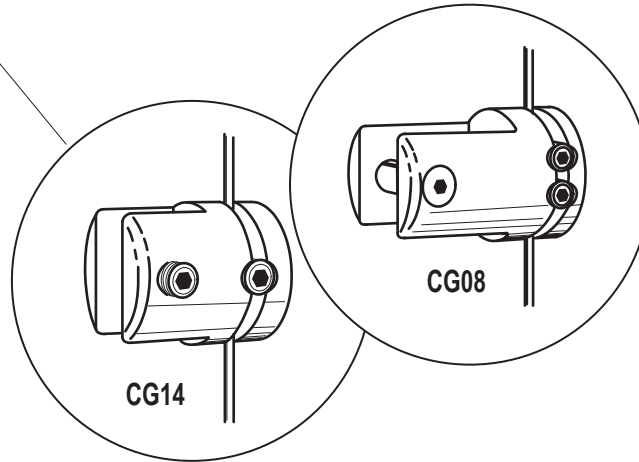

7) Using CG08 clamp support require drilling the panel (fig 2).

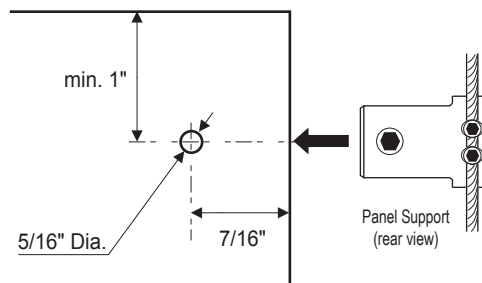
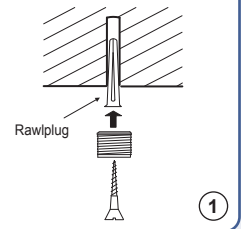

fig 2

INSTALLATION TIPS

Concrete



Wood

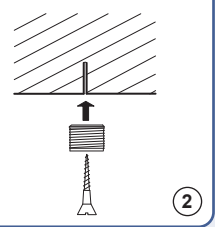

Lathe & Plaster

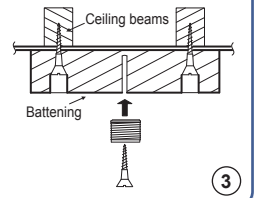

Plasterboard

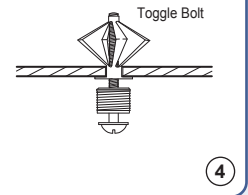

Suspended Ceiling

