

6mm Rod Display Systems – INSTALLATION GUIDELINES

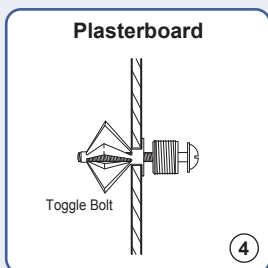
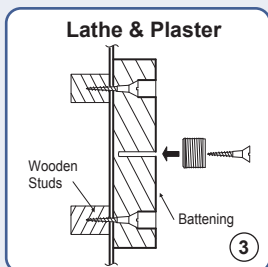
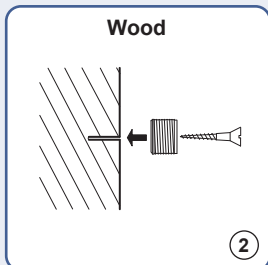
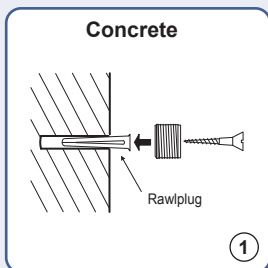

Angled Top to Floor (RAAS) Rod Installation

IMPORTANT: It is essential to check that the top ceiling fixings are strong enough to take the weight of the items being displayed, whilst allowing for the tension in the rods.

1) Select the upper height at which rod is to start. Fix part (A) of the top angled fitting to wall, using a suitable fixing for the type of wall:

- for wooden walls use a wood screw.
- for a cavity wall use a spring toggle bolt.
- for a solid wall use a rawlplug and screw.

2) Screw part (B) into part (A) and adjust the angle as shown in step (H).

3) Using a plumb-line, plumb down from (A) and fix floor fitting (F) to floor, using appropriate type of fixing.

4) Screw rod into top fitting (A-B) using a left hand thread and add as many additional rods as required.

5) Cut bottom rod in line with the decorative line around floor fitting (F).

6) Slide tensioner (C), spring (D) and rod grip (E) onto the rod. Tighten grip (E) to the end of the rod with allen key provided.

7) Adjust the tension of the rod by screwing tensioner (C) into floor fitting (F). See (G) below.

N.B. It is important to check the strength of the top fixing. No responsibility will be taken for incorrect fixing. This responsibility rests with the installer.

Rods are not supplied with fixing screws.

