

1.5mm Cable Display Systems - INSTALLATION GUIDELINES

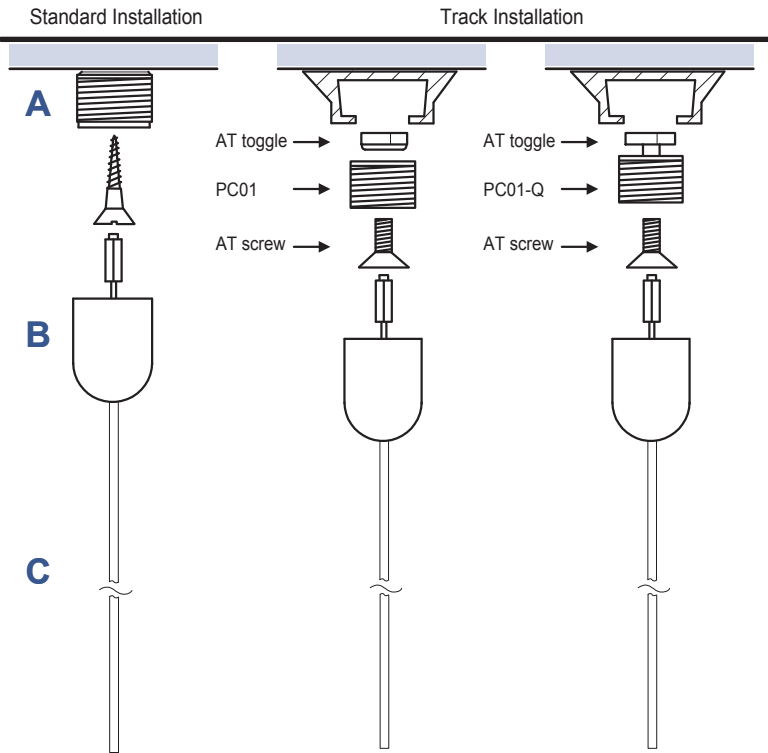
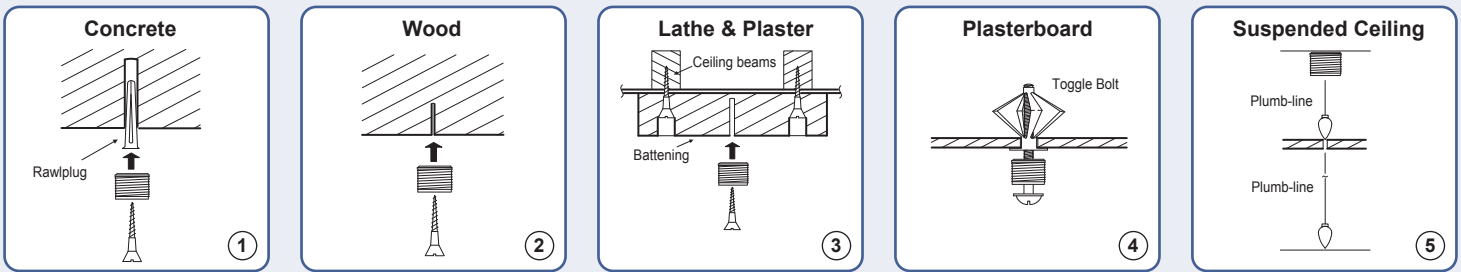

Top (C2) - Cable Installation

IMPORTANT: It is essential to check that the top ceiling fixings are strong enough to take the weight of the items being displayed, whilst allowing for the tension in the cables.

- 1) Fix fitting (A) to ceiling:
 - for wooden ceilings use a wood screw.
 - for cavity ceilings use a spring toggle bolt.
 - for solid ceilings use a rawlplug and screw.
- 2) For Channel Fixing use Quick Fit Toggle (PC01-Q) or Toggle (AT)
- 3) Screw fitting (B) to fitting (A).
- 3) To complete the application attach to cable the panel or shelf fittings at desire location.

N.B. It is important to check the strength of the top fixing. No responsibility will be taken for incorrect fixing. This responsibility rests with the installer.

Cables are not supplied with fixing screws.

