

6mm Rod Display Systems - INSTALLATION GUIDELINES

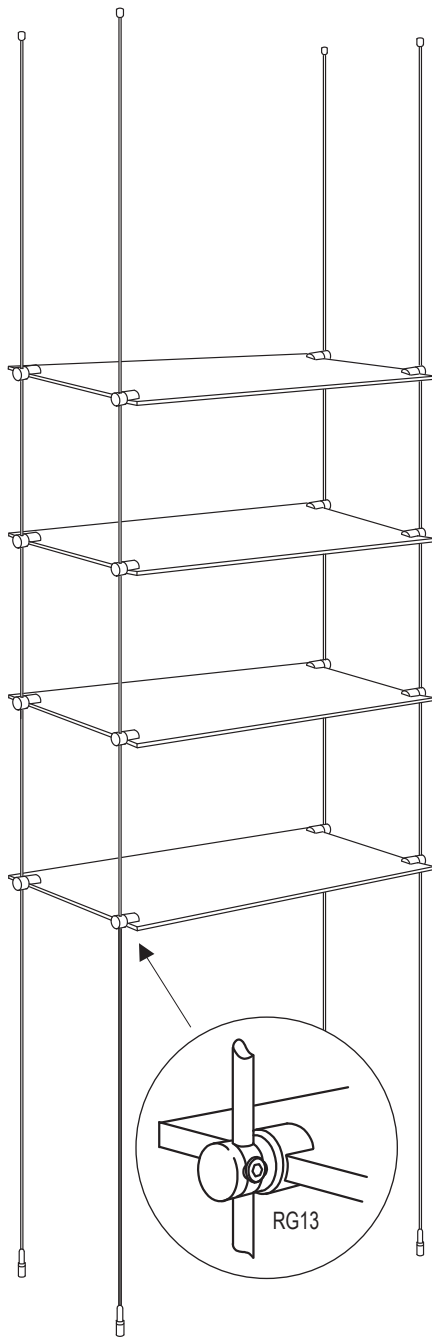

Glass Shelving Fixing - RG13 Support Installation

1) Attach a clamp support to each corner of the glass shelves at 3/4"-1" distance from edge (fig 1).

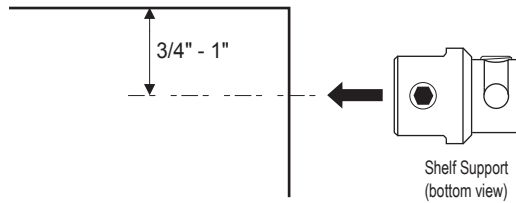

fig 1

2) **Mark rod positions on floor area** - lay shelves on floor and mark rod positions or use measurements. With the use of a plumb line mark and fix rods to ceiling (ensuring that fixings are secure).

3) Install rods as per "Rod Fixing Instructions" for RAS supplied.

4) **Shelf fitting** - As a guideline the lowest shelf should be fixed approx. 24" from the floor and subsequent shelves approx 12" apart.

5) **Fix shelf to rods**. Adjust shelf to horizontal, preferably with a spirit level. Repeat procedure for other shelves.

Options - Double sided Clamp Supports

1) The double sided clamp support R23 will need to be fitted to the rod before the second glass shelf is attached.

2) For proper and easier installation it will require two man assistance.

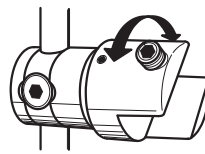

RG13

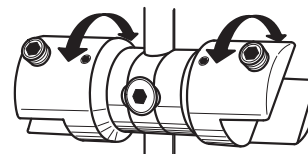

RG23

Options - Side & Front Shelf Clamp Fixing

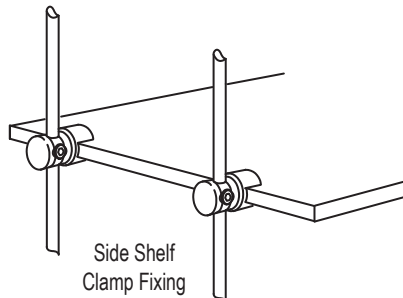

Side Shelf
Clamp Fixing

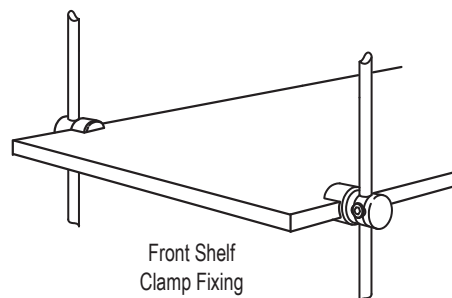

Front Shelf
Clamp Fixing

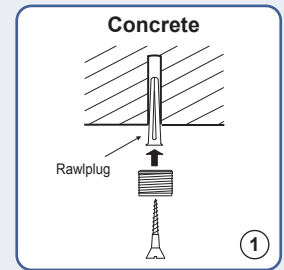

1

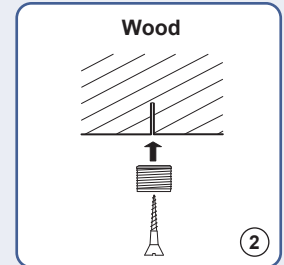

2

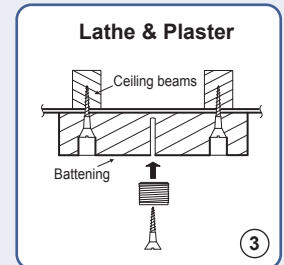

3

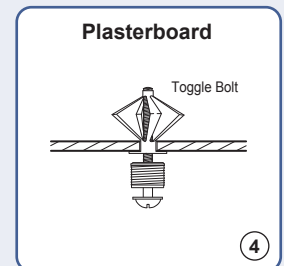

4

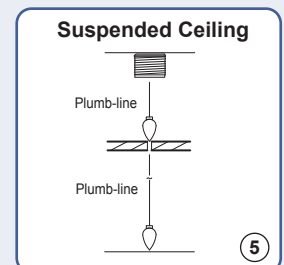

5