



ONLINE CATALOG

3.0mm (1/8") Dia. Cable Display Systems

Features & Components



CONTACT INFORMATION

- To Order Products, Check Status of Your Order or Track Your Package... call toll free **800-753-9688**
- Send Your Inquires, Questions or Comments to **info@novadisplay.com**
(For assistance with general questions or actual display projects, please fax or e-mail us a short description and a graphical attachment. For best results, please send us a rough sketch or a project lay-out with dimensions and any special details. Using your drawing, we will generate a quote and specification sheet for the parts that lists the pricing, availability, delivery time, etc. You will receive a copy for review before ordering)
- For more information on our products and services, including pricing, technical information, and installation instructions visit our website at **www.novadisplay.com**
- You are also invited to visit our Online Store at **www.store.novadisplay.com**, where you will find various concept ideas and a comprehensive range of standard "Display Kits".

1626 Piner Road
Santa Rosa, CA 95403

1.800.753.9688 toll
1.800.753.0856 fax

1.707.535.0253 tel
1.707.535.0254 fax

www.novadisplay.com
www.store.novadisplay.com

info@novadisplay.com
sales@novadisplay.com

Cable Display Systems

3.0mm Cables & Fittings

CABLE W/CEILING TO FLOOR FIXINGS

Supplied with 4M (13' 1-1/2") Long Cable

- The basic kit for fixing between ceiling & floor.
- Includes Spring Tensioner, Top and Bottom Fixings.

Length: 4m (13' 1-1/2"), Top Fixing: 16mm (5/8") Diameter, Bottom Fixing: 15mm (19/32") Diameter.

* Cables can be supplied in longer length.

CA4-3	Satin Chrome	073
CA4-3/PC	Polished Chrome	
CA4-3/BR	Polished Brass	



- 3.0mm cable supports up to 200kg (441lbs), giving all the advantages of a robust appearance with the smallest size supports on the market. Fittings have the same cable centers as 1.5mm cable.
- Use same installation accessories for 3.0mm cables as for 1.5mm cables.



HARDWARE OPTIONS

- Use heavy duty ceiling support on page 18 with 1.5mm or 3.0mm cable sets for better fixing.

VERTICAL SUPPORT - SINGLE

- For panels up to 7mm (1/4") thick.
- Holes not required.

Size: 21mm (53/64") Length, 16mm (5/8") Diameter.

CG01-3	Satin Chrome	074
CG01-3/PC	Polished Chrome	
CG01-3/BR	Polished Brass	

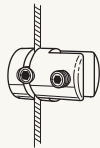

VERTICAL SUPPORT - SINGLE

- For panels up to 12.7mm (1/2") thick.
- Holes not required.

Size: 21mm (53/64") Length, 20.5mm (13/16") Diameter.

CG14-3	Satin Chrome	075
CG14-3/PC	Polished Chrome	
CG14-3/BR	Polished Brass	

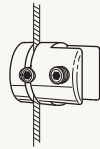

MULTI-POSITION CLAMP SUPPORT FOR PANELS & SHELVES - SINGLE

- For panels or shelves up to 7mm (1/4") thick.
- Adjustable to any angle. Can be locked into position.
- Holes not required.

Size: 28mm (1-7/64") Length, 16mm (5/8") Diameter.

CG11-3	Satin Chrome	076
CG11-3/PC	Polished Chrome	
CG11-3/BR	Polished Brass	

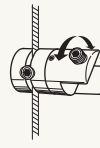

MULTI-POSITION CLAMP SUPPORT FOR PANELS & SHELVES - DOUBLE

- For panels or shelves up to 7mm (1/4") thick.
- Adjustable to any angle. Can be locked into position.
- Holes not required.

Size: 46mm (1-13/16") Length, 16mm (5/8") Diameter.

CG21-3	Satin Chrome	077
CG21-3/PC	Polished Chrome	
CG21-3/BR	Polished Brass	

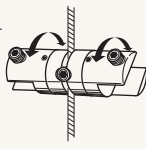

MULTI-POSITION CLAMP SUPPORT FOR PANELS & SHELVES - SINGLE

- For panels or shelves up to 10mm (3/8") thick.
- Adjustable to any angle. Can be locked into position.
- Holes not required.

Size: 28mm (1-7/64") Length, 18mm (45/64") Diameter.

CG13-3	Satin Chrome	078
CG13-3/PC	Polished Chrome	
CG13-3/BR	Polished Brass	

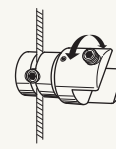

CONCEPT IDEAS

- Various shaped glass shelves available to order...

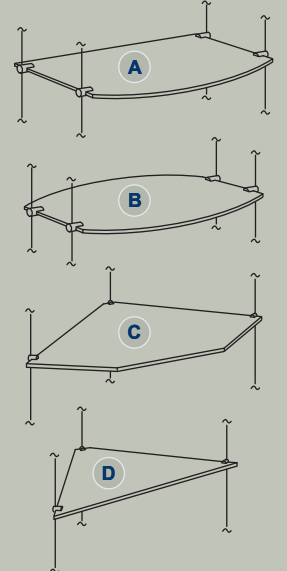

FINISH OPTIONS:

Standard finishes: Satin Chrome, Warm Chrome, Black, Polished Chrome, Brass.
Special finishes available on request.

Cable Display Systems

Panel Supports for 3.0mm Cables

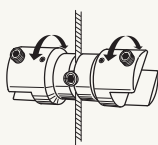

MULTI-POSITION CLAMP SUPPORT FOR PANELS & SHELVES - DOUBLE

- For panels & shelves up to 10mm (3/8") thick.
- Adjustable to any angle. Can be locked into position.
- Holes not required.

Size: 46mm (1-13/16") Length, 18mm (5/8") Diameter.

CG23-3	Satin Chrome	079
CG23-3/PC	Polished Chrome	
CG23-3/BR	Polished Brass	

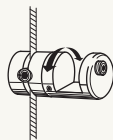

TOP/BOTTOM MULTI POSITION SUPPORT - SINGLE

- For panels up to 7mm (1/4") thick.
- For panels wider than the distance between cables.
- Adjustable to any angle. Can be locked into position.

Size: 31mm (1-7/32") Length, 16mm (5/8") Diameter.

CG12-3	Satin Chrome	080
CG12-3/PC	Polished Chrome	
CG12-3/BR	Polished Brass	

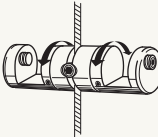

TOP/BOTTOM MULTI POSITION SUPPORT - DOUBLE

- For panels up to 7mm (1/4") thick.
- For panels wider than the distance between cables.
- Adjustable to any angle. Can be locked into position.

Size: 52mm (2-3/64") Length, 16mm (5/8") Diameter.

CG22-3	Satin Chrome	081
CG22-3/PC	Polished Chrome	
CG22-3/BR	Polished Brass	

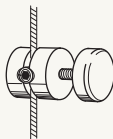

SUPPORT FOR PANELS WITH HOLES - SINGLE

- To hold standard panels 7mm (1/4") thick.
- Hole size 6mm (15/64") Dia.

Size: 24.5mm (31/32") Length, 16mm (5/8") Diameter.

CS13-3	Satin Chrome	082
CS13-3/PC	Polished Chrome	
CS13-3/BR	Polished Brass	

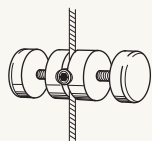

SUPPORT FOR PANELS WITH HOLES - DOUBLE

- To hold standard panels 7mm (1/4") thick.
- Hole size 6mm (15/64") Dia.

Size: 38.5mm (1-33/64") Length, 16mm (5/8") Diameter.

CS23-3	Satin Chrome	083
CS23-3/PC	Polished Chrome	
CS23-3/BR	Polished Brass	

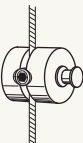

HOOK - SINGLE

- For panels up to 3mm (1/8") thick with holes.

Size: 17mm (43/64") Length, 16mm (5/8") Diameter.

CH01-3	Satin Chrome	084
CH01-3/PC	Polished Chrome	
CH01-3/BR	Polished Brass	

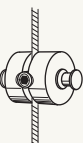

HOOK - DOUBLE

- For panels up to 3mm (1/8") thick with holes.

Size: 24mm (15/16") Length, 16mm (5/8") Diameter.

CH02-3	Satin Chrome	085
CH02-3/PC	Polished Chrome	
CH02-3/BR	Polished Brass	

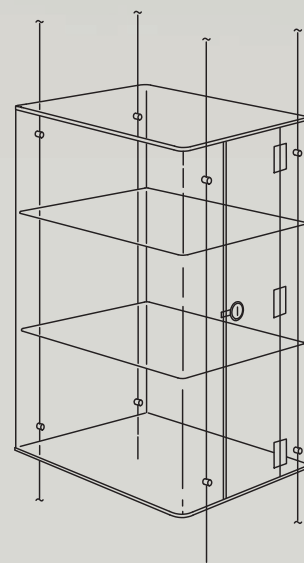

TIME SAVING TIPS

- Use drilled and slotted shelves with CS01 & CS01-3. Shelves can be removed for cleaning without using tools.

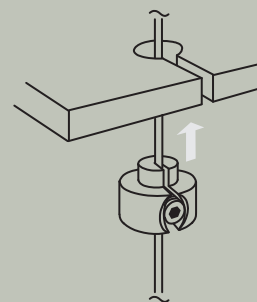

PRODUCT INFO:

For more information on cable/rod display systems, including pricing, specifications, and installation instructions visit our website at www.novadisplay.com

ORDERING TIP:

CS13-3 & CS23-3 - For extra thick panels up to 20mm (25/32"), specify size required. For example: CS13-3/S/xx

Cable Display Systems

Shelf Supports for 3.0mm Cables

SUPPORT FOR SCREW FIX PANEL - SINGLE

- For any item fitted with boss ref. P02 (see below) or banner/hanging rail.

Size: 14mm (35/64") Length, 12mm (15/32") Internal Diameter, 6mm (15/64") Internal Depth, 16mm (5/8") Diameter.

CS03-3	Satin Chrome	086
CS03-3/PC	Polished Chrome	
CS03-3/BR	Polished Brass	



BOSS FOR USE WITH SUPPORTS

- Ref. CS03 or CS04. Use with up to no. 10 countersunk wood screw or bolt.

Size: 12mm (15/32") Diameter, 6mm (15/64") Depth.

P02	Nickel	087
-----	--------	-----



SUPPORT FOR SHELVES WITH HOLES

- Locates under shelf.
- Shelf is drilled and slotted.
- Inconspicuous.

Size: 8mm (5/16") Depth, 16mm (5/8") Diameter.

CS01-3	Satin Chrome	088
CS01-3/PC	Polished Chrome	
CS01-3/BR	Polished Brass	

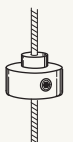

CLAMP SUPPORT FOR GLASS SHELVES - SINGLE

- For Glass or Acrylic Shelves - up to 12.7mm (1/2") thick.
- Holes not required.

Size: 20mm (25/32") Length, 21mm (53/64") Diameter.

CG15-3	Satin Chrome	089
CG15-3/PC	Polished Chrome	
CG15-3/BR	Polished Brass	

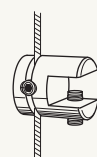

SUPPORT FOR WOODEN OR GLASS SHELVES - SINGLE

- Adjustable to any angle of slope.
- Can be locked into position.
- For glass shelves add ref. P08.

Size: 37mm (1-29/64") Length, 16mm (5/8") Diameter.

CS11-3	Satin Chrome	090
CS11-3/PC	Polished Chrome	
CS11-3/BR	Polished Brass	

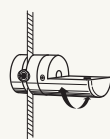

SUPPORT FOR WOODEN OR GLASS SHELVES - DOUBLE

- Adjustable to any angle of slope.
- Can be locked into position.
- For glass shelves add ref. P08.

Size: 64mm (2-33/64") Length, 16mm (5/8") Diameter.

CS21-3	Satin Chrome	091
CS21-3/PC	Polished Chrome	
CS21-3/BR	Polished Brass	

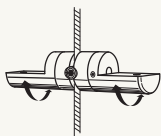

SCREW TO RETAIN GLASS SHELVES

- Supported on CS11-3 or CS21-3 to hold 6mm (15/64") thick as standard.
- Flush Finish. Plastic insert to protect glass.

Size: 16mm Dia., 6mm Dia. Hole, 12mm from the edge of the glass.

P08	Satin Chrome	092
P08/PC	Polished Chrome	
P08/BR	Polished Brass	



- Use CS03-3 supports with banner rails or hanging rails on page 12

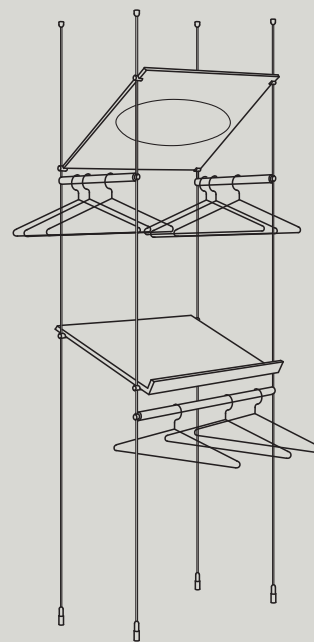

HARDWARE OPTIONS:

P08 - Flush finish. Plastic insert to protect glass. Hole 6mm (15/64") Dia., 6mm (15/64") thick glass, 12mm (15/32") from the edge of glass.

FINISH OPTIONS:

Standard finishes: Satin Chrome, Warm Chrome, Black, Polished Chrome, Brass. Special finishes available on request.

Cable Display Systems

Special Fittings for 3.0mm Cables



SUPPORT FOR ROD - SINGLE

- For 6mm (15/64") Dia. Rod
 - Rods will banners & graphic presentations.
- Size: 14mm (35/64") Length, 16mm (5/8") Diameter.

CS05-3	Satin Chrome	093
CS05-3/PC	Polished Chrome	
CS05-3/BR	Polished Brass	



HEAVY DUTY CEILING SUPPORT

- Can be used with any standard ceiling or wall mounting fittings.
- Supplied with 1-1/2" long wood screws.

50mm (2") Diameter, 5mm (3/16") Depth

HDS	Satin Chrome	094



DECORATIVE SUPPORT PLATE

- Can be used with any standard ceiling or wall mounting fittings.

37mm (1-1/2") Diameter, 5mm (3/16") Depth

P01-PC01	Satin Chrome	095



DECORATIVE COVER DISK

- For 3mm cable or rod. Use below false ceiling to hide hole, giving a professional finish.

25mm (1") Diameter, 5mm (3/16") Depth

CD-4	Satin Chrome	096

New Item



GOTCHA STRIPS

- Aluminum banner rails with clear plastic gripper strip. Ready to be used with cables or rods.

- Quick and easy way to suspend large posters. The clear plastic strips simply clip the poster into position, holding it firmly in place.

AGS-12	12" Width
AGS-24	24" Width
AGS-36	36" Width
AGS-40	40" Width
AGS-48	48" Width
AGS-60	60" Width

* CS03 or RS03 supports not included.



Restaurant & Bar ▶

◀ Dining Rooms

◀ Training Room

◀ Board Room

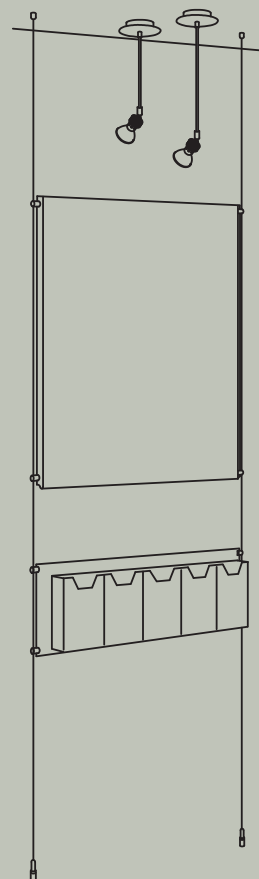

DISPLAY KITS

- For easy ordering go to our Online Store at www.store.novadisplay.com, where you will find various concept ideas and a comprehensive range of standard "Display Kits".

PRODUCT INFO:

For more information on cable/rod display systems, including pricing, specifications, and installation instructions visit our website at www.novadisplay.com

Cable Display Systems

Installation Accessories for 1.5mm & 3.0mm Cables

POWER CONNECTOR

- Allows electrical power to be connected to the cable.
- Excellent connection.

Size: 12mm (15/32") Diameter, 12mm (15/23") Length.

CS08	Satin Chrome	062
CS08-3	Satin Chrome	

* Use CS08-3 power connector with 3mm (1/8") Dia. Cable or Rod System.

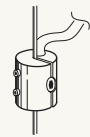

TOP ISOLATOR

- Black nylon for cables.

Size: 16mm (5/8") Diameter.

PC01/I	Black	063



BOTTOM ISOLATOR

- 3 sections in white nylon.

SP/IS	White	064



QUICK FIT TOGGLE

- Brass toggle that screws into the top end of a cable or wall fitting.
- Unit fits directly into almost any make of channel.
- Invisible when used

PC01-Q	Brass	065

* Not to be used with lighting.



TOGGLE

- For fixing cables to channels. Can be used with all top and bottom fittings.
- Allen key provided.

AT	Silver	066
AT/S	Silver	
AT/L	Silver	

* For fixing cable/rod fittings to channel order AT

* For fixing MSB brackets to channel order AT/S

* Long version AT/L for use with isolators.



DECORATIVE SUPPORT PLATE

- Add to any of the cable / rod systems fittings.

Size: 38mm (1-1/2") Diameter.

P01	Satin Chrome	067
P01/PC	Polished Chrome	
P01/BR	Polished Brass	



SINGLE WALL BRACKET

- Available in 3 sizes. All units can be fitted to the wall using up to no. 10 screws. Supplied with nut and bolt to connect cable to bracket.

MSB-25: 30mm (1-3/16") Height, 35mm (1-3/8") Depth, Cable Fixing: 25mm (63/64") from wall.

MSB: 60mm (2-23/64") Height, 60mm (2-23/64") Depth, Cable Fixing: 50mm (1-31/32") from wall.

MSB-100: 110mm (4-21/64") Height, 110mm (4-21/64") Depth, Cable Fixing: 100mm (3-15/16") from wall.

MSB-25	Silver	068
MSB	Silver	
MSB-100	Silver	

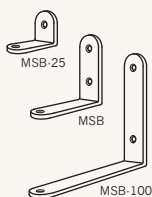

INSTALLATION TIPS

Low Voltage Lighting

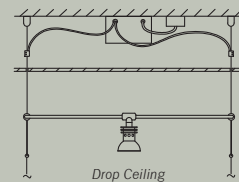

Drop Ceiling

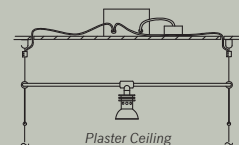

Plaster Ceiling

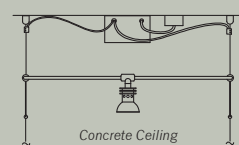

Concrete Ceiling



- Quick Fit Toggle fits directly into almost any make of channel with 1/4" to 3/8" opening.



ORDERING TIP:

Toggle Fixing - Long version for use with isolators - order AT/L.

ORDERING TIP:

Order suitable toggle to connect the cable to the channel. Choose from PC01-Q Quick Toggle or AT Toggle Fixing.

Cable Display Systems

Installation Accessories for 1.5mm & 3.0mm Cables

Channel solves many installation challenges:

- Use channel when you wish to change the poster sizes and need different cable/rod centers.
- Use channel to create a feature area.
- Use channel to bring the display away from the wall or window.
- Use channel to bridge over a poor fixing area.
- Channel allows tremendous fixing flexibility. You can position cables anywhere along their length.

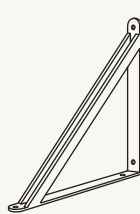

TRIANGULAR WALL BRACKET

- Supplied with 2 nuts and bolts to connect cables to brackets.
 - Supports 2 cables 300mm (11-7/8") apart.
 - Hi-tech appearance.
 - Can be used as a canopy of a sign support.
- Size: 350mm (1'1-25/32") Height, 350mm (1'1-25/32") Depth, Cable project from the wall 40mm (1-37/64") and 340mm (1'1-25/64").

MDB Silver

069



REBATE CHANNEL

- For ceiling or floor mounting. Cables or rods are fully moveable along the channel.
- For rebating into ceiling, floor, or shelves with a flush finish.

Size: 11.5mm (29/64") High; 19mm (7/8") Wide; 8.5mm (5/16") Channel Opening.

AC-10 Silver: 10 Feet

AC-8 Silver: 8 Feet

AC-4 Silver: 4 Feet

* AC-10 channel ships only in bulk via freight.

070



DOVETAIL CHANNEL

- For floor mounting. Cables or rods are fully moveable along the channel.
- Stylish appearance.

Size: 11.5mm (29/64") High; 28mm (1-7/64") Wide; 8.5mm (5/16") Channel Opening.

ACD-8 Silver: 8 Feet

ACD-4 Silver: 4 Feet

071

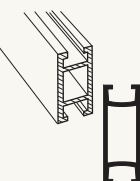

DOUBLE SIDED CHANNEL (*PH1005)

- For wall mounting with MSB wall brackets and toggles.

Size: 46mm (1-13/16") High; 19mm (7/8") Wide; 8.5mm (5/16") Channel Opening.

ACL-8 Silver: 8 Feet

ACL-4 Silver: 4 Feet

072

Miscellaneous / Cables & Set Screws



BARE CABLE

- Additional 1.5mm (1/16") and 3.0mm (1/8") diameter cables are available in two standard lengths.

- Supplied with copper couplings.

BC4 (BC4-3) 4m (13') Long

BC5 (BC5-3) 5m (16'-3") Long

* Cables can be supplied in longer length.

GRUB SCREWS FOR FITTINGS

- Spare grub screws for use with 1.5mm (1/16") and 3.0mm (1/8") diameter cable fittings.

P13G/S M3 x 3mm

P12 M3 x 6mm

P11 M5 x 6mm

P16 M4 x 6mm

P18 M4 x 4mm

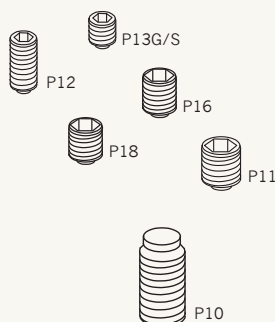

NYLON TIPPED SCREWS

- Protects glass and acrylic from damage.

P10 M6 x 10mm

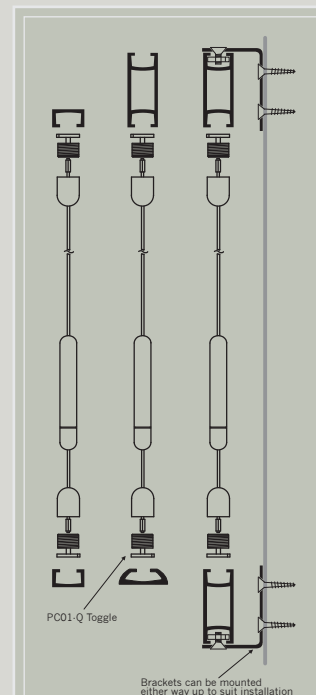

INSTALLATION TIPS

Channel Assembly

- Use rebate channel for ceiling or floor assembly.
- Use the dovetail (threshold) channel for floor assembly only.
- Use double sided channel for wall assembly or for ceiling assembly with heavier loads.

ORDERING TIP:

For more information on cable/rod display systems, including pricing, specifications, and installation instructions visit our website at www.novadisplay.com

Ordering, Payment & Return Policies

Ordering Policy

To start your order first, carefully review the product and service information on our web site, if you don't see exactly what you want, please contact us regarding availability, size, and quantity requirements for your project. Make sure you have decided on exactly what you need. Then, consult us on all your questions regarding our products, components and parts, because many of components can be easily confused. Contact us to receive a quote for your project. After placing an order, the customer receives via fax or e-mail a Customer Order Acknowledgment, which indicates in detail descriptions of items and pricing. Orders will not be processed without Nova Display, Inc. receiving a signed copy of said Customer Order Acknowledgment. Make sure to review and initial all areas. All changes to your orders of stock merchandise can be modified no later than 24 hours after receiving your order. We will call or fax you immediately should something change concerning your order.

Sample Policy

Nova Display, Inc. will provide samples for your testing and inspection. Most samples are supplied at 40% discounted cost (plus UPS Charges). If you need to order components for a prototype or fabrication of a prototype, please contact us for a quotation.

Payment Policy

All orders are shipped F.O.B Nova Display. We accept Visa, or Master Card, in addition to Money Orders, Cashier's Checks and Business/Personal Checks. For orders by phone, you may pre-pay your order via check or wire transfer. Orders prepaid with a check will be shipped within 24 hours of check clearance. New customers wishing to prepay an order totaling \$5,000 or more must allow 10 business days for their check to clear. This policy applies to personal, business, cashiers, and certified checks, as well as money orders.

Overseas customers may pay by Credit Card or Bank T/T at the time of shipment. We do not charge your credit card for any item until it is shipped, this doesn't apply to customized and non-standard items. All credit card orders are subject to credit verification and approval. For your protection, credit card orders shipped to an address other than your billing address may require additional verification.

Qualified businesses or organizations will be given Net 30 terms upon approved credit. In order to open an account, please provide a bank reference and three trade references. Customers with established credit are expected to pay NET within specific terms of their account, pre-established credit limits, and our standard Terms and Conditions, otherwise the line of credit will be discontinued.

All Custom Orders require a 50% Deposit before start of fabrication. Remainder due prior to shipping unless other terms have been determined by Nova Display, Inc. Credit Department.

All pricing and specifications are subject to change, without prior notice. Freight, handling and insurance will be added to your order. Please call for current pricing and availability. Send payments to: Nova Display, Inc., 1626 Piner Road, Santa Rosa, CA 94503

We also suggest you to use our automated ordering system when placing an order, or buying our products online. We accept electronic check payments via PayPal. It also allows you to make payments using VISA / Master Card / American Express. If you don't want to use our secure ordering system or are having problems using it call us toll free: 800-753-9688.

Quality Policy

All merchandise is produced to standard and commercial tolerances. Nova Display, Inc. warranties product to be free from defects in workmanship and material. When Nova Display has determined that a product is defective, it will be replaced. Nova Display liability is limited to the cost of the defective product. No other warranty is expressed or implied.

Shipping Policy

90% of orders on finished products are shipped out within 2-15 business days from our sales/distribution center. The custom made products or components which are not available in stock at the moment of ordering will be shipped in 2-8 weeks. Most orders are shipped via UPS or FedEx, unless otherwise specified. We offer express air and economical two day air service on most items in stock. For large orders, we'll ship freight collect by the most reliable and inexpensive carrier to your location.

Return Policy

Inspect all your shipment immediately upon arrival. If your order is not received in satisfactory condition, keep all packaging and notify us within (3) days of receipt. Stock merchandise in original, unopened packaging may be returned for refund within fifteen (15) days of receipt. Items must be in their original state (undamaged). Shipping and handling charges for returned items are non-refundable. All returns must be accompanied by the order statement. You may want to insure your return. We cannot be responsible for lost or misdirected returns. If you paid for your order by credit card, a credit will be issued and will appear on your billing statement. Returns must be insured for the invoiced value of the merchandise. Please note that custom merchandise is not returnable. A 15%-30% restocking fee will be charged on all returns. If you have any questions, ask your salesperson for details. Merchandise must be returned to: Nova Display, Inc., 1626 Piner Road., Santa Rosa, CA 95403-1908



*"All you need to create
high impact displays..."*

Lobbies

Receptions

Showrooms

Windows

Corridors

Exhibitions

Museums

Galleries

Offices

Retail Outlets

Banks

Point-of-Sale

Airports

Shopping Malls

Sport Arenas

Hotels

Universities

Colleges