

Installation Guidelines

1.5mm Cable Display Systems

800.753.9688 • www.novadisplay.com

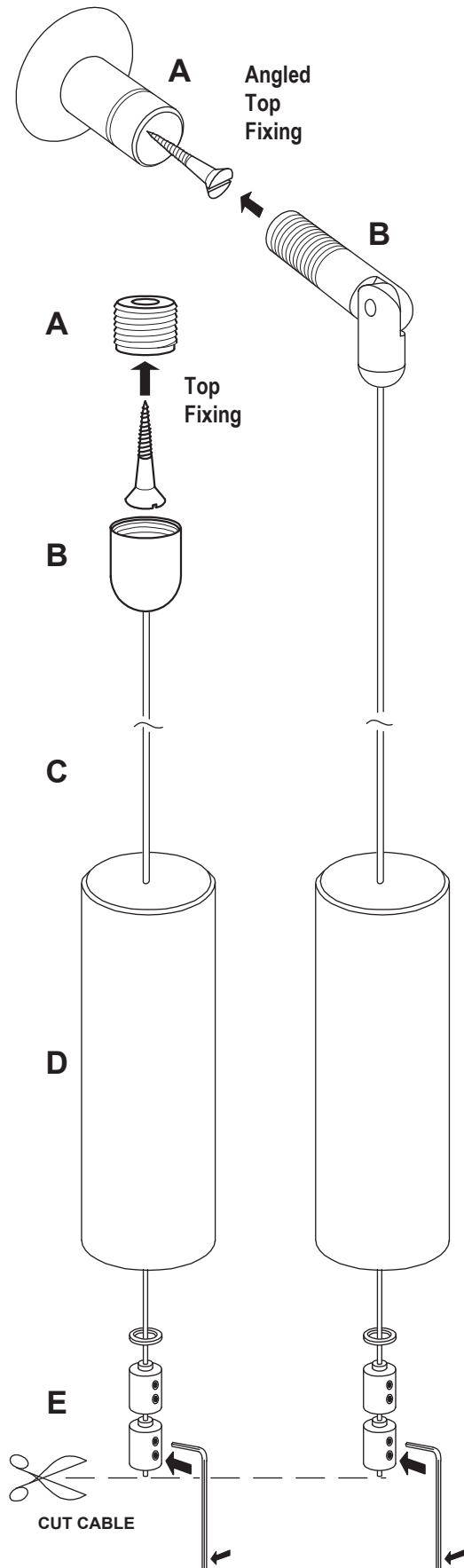

INSTALLATION TIPS

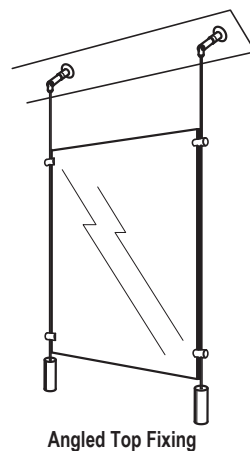
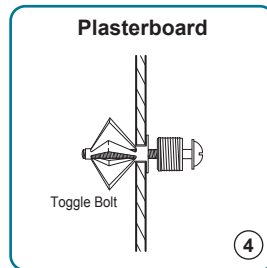
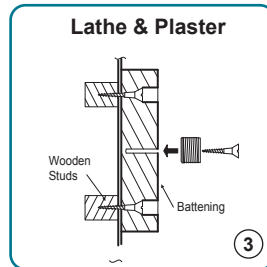
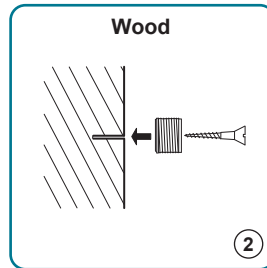
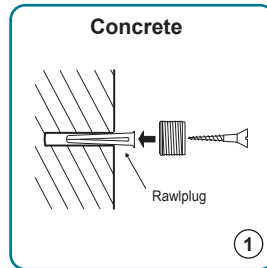

WEIGHTED BOTTOM (CCT & CAT) - Cable Installation

IMPORTANT: It is essential to check that the top ceiling fixings are strong enough to take the weight of the items being displayed, while allowing for the tension in the cables.

- 1) Select the upper height to which the cable is to start. Affix base fitting (A-B) to wall/ceiling using a suitable fixing for the wall type:
 - for wooden walls use a wood screw.
 - for a cavity wall use a spring toggle bolt.
 - for a solid wall use a rawplug and screw.
- 2) Loosen the grub screws in fitting (E), using the Allen key provided, and slide fittings (E) to weight (D) up the cable.
- 3) Pull down and cut off cable at desired length.
- 4) Tighten fittings (E) on the end of the cable.

Note: It is important to check the strength of the top fixing(s). NOVA DISPLAY® takes no responsibility for incorrect installation. This responsibility rests with the installer.

Cables are not supplied with fixing screws.

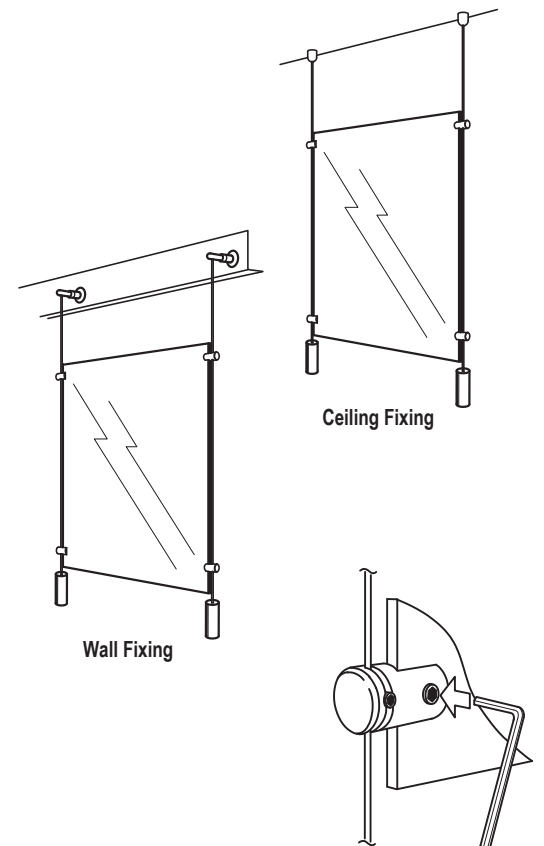

Graphic/art panels, posters, mirrors, etc. - suspended using cables suspensions system. It can be fixed direct to the wall, ceiling, channel, or angled surfaces.