

Glass Shelving Fixing - RG13 Support Installation

- 1) Attach a clamp support to each corner of the glass shelf at 3/4"-1" distance from edge (fig 1).

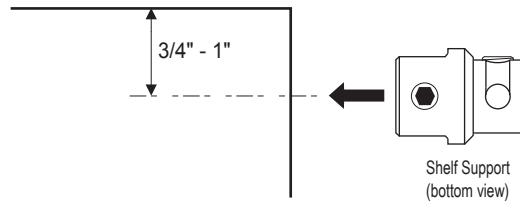
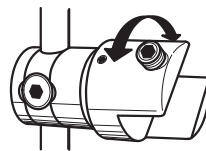

fig 1

- 2) **Mark rod positions on floor area** - Lay shelves on floor and mark rod positions, or use measurements. With the use of a plumb line mark and fix rods to ceiling (ensuring that fixings are secure).
- 3) Install rods as per "**Rod Fixing Instructions**" for RAS supplied.
- 4) Shelf fitting - As a guideline; the lowest shelf should be fixed approx. 24" from the floor and subsequent shelves approx 12" apart.
- 5) Fix shelf to rods. Adjust shelf horizontally, preferably with a spirit level. Repeat procedure for other shelves.

Options - Double sided Clamp Supports

- 1) The double sided clamp support **R23** will need to be fitted to the rod before the second glass shelf is attached.
- 2) For proper and easier installation it will require two people.



RG13

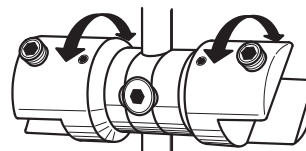

R23

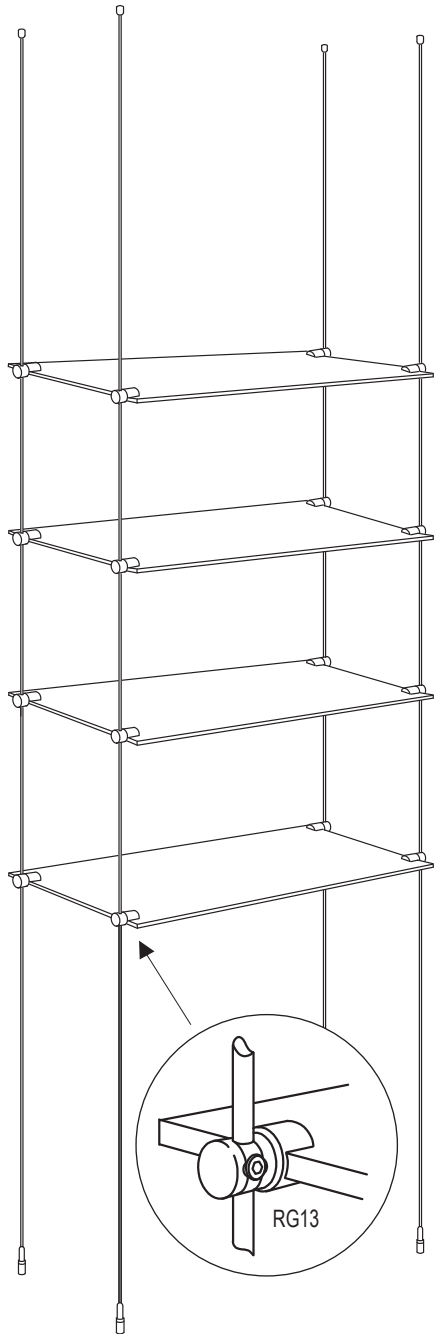

Installation Tips

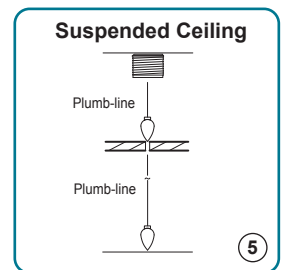
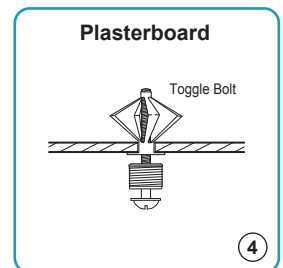
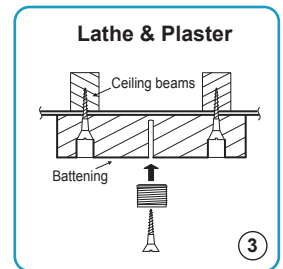
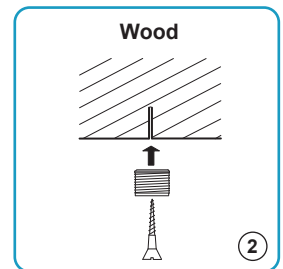
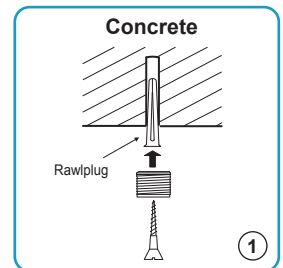

Options - Side & Front Shelf Clamp Fixing

